

# primo

**MINI/MIDI**

**AUDITS**

westomatic  
*make it happen*



# primo

## MINI/MIDI



Westomatic

# Saving Counters

## SAVING COUNTERS:

You can save the recipe counter on an SD Card.

The software Notepad++ is used to read the data - it's a free download available to everyone.

```
1 Generated on Fr, 30-07-2021, 14:54:55
2 Software version: V1.0.1207
3 Machine number: -
4
5 =====
6 = SERVICE COUNTERS =
7 =====
8 Mixer rinse: 2
9 Mixer clean: 0
10 Filter liters done: 9
11 Filter liters left: 2391
12 Filter months done: 0
13 Filter months left: 12
14 Operating days: 9
15
16 =====
17 = CUSTOMER RECIPES (small) =
18 =====
19 Name
20 000 COFFEE
21 001 ESPRESSO
22 002 COFFEE MILK
23 003 CAPPUCCINO
24 004 JUG COFFEE
25 005 JUG HOT WATER
26 006 COFFEE BLACK
27 007 HOT WATER
```

|     | Free | Low rate | High rate |
|-----|------|----------|-----------|
| 0 0 | 0    | 0        | 0         |
| 0 0 | 0    | 0        | 0         |
| 0 0 | 0    | 0        | 0         |
| 0 0 | 0    | 0        | 0         |
| 0 0 | 0    | 0        | 0         |
| 0 0 | 0    | 0        | 0         |
| 0 0 | 0    | 0        | 0         |
| 0 0 | 0    | 0        | 0         |
| 0 0 | 0    | 0        | 0         |
| 0 0 | 0    | 0        | 0         |
| 0 0 | 0    | 0        | 0         |
| 0 0 | 0    | 0        | 0         |

## SAVING COUNTERS:

Place the SD Card into the machine.

- Open the rubber cover on the side of the screen.
- Insert the SD Card - golden contacts should face towards you.



## SAVING COUNTERS:

From the SERVICE MENU  
08 SOFTWARE  
02 SAVE DATA

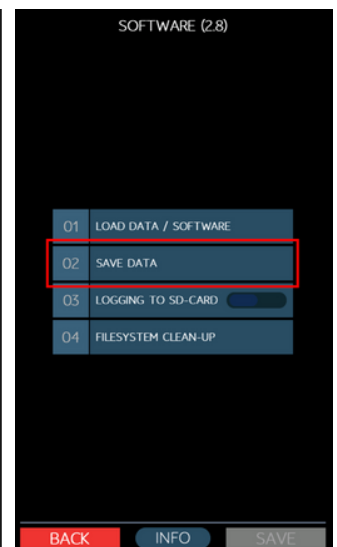
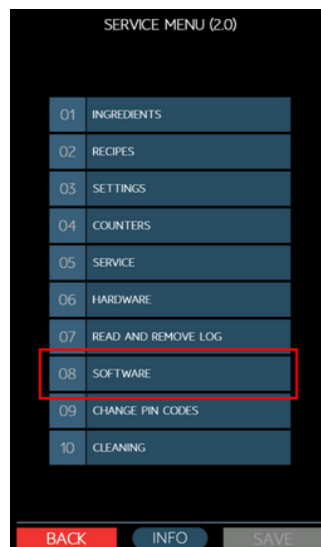

# primo



Westmatic

## MINI/MIDI

# Saving Counters

### SAVING COUNTERS:

#### Save Data (2.8.2)

- Select 03 COUNTERS and press OK to save the .cnt file on the SD Card.
- The counter file is saved on the SD Card / Reports / xxxxxx.cnt



### SAVING COUNTERS:

#### Remove the SD Card



### SAVING COUNTERS:

Use Notepad++ on your computer to open the counter file on the SD Card / Reports / xxxxxx.cnt

#### The file shows you:

- The time/date the log file was generated
- Software version
- Machine number
- Service counters
- Recipe counters

```
1 Generated on Fr, 30-07-2021, 14:54:55
2 Software version: V1.0.1207
3 Machine number: -
4
5 =====
6 = SERVICE COUNTERS =
7 =====
8 Mixer rinse: 2
9 Mixer clean: 0
10 Filter liters done: 9
11 Filter liters left: 2391
12 Filter months done: 0
13 Filter months left: 12
14 Operating days: 9
15
16 =====
17 = CUSTOMER RECIPES (small) =
18 =====
19 Name Free Low rate High rate
20 000 COFFEE 0 0 0 0 0 0 0
21 001 ESPRESSO 0 0 0 0 0 0 0
22 002 COFFEE MILK 0 0 0 0 0 0 0
23 003 CAPPUCCINO 0 0 0 0 0 0 0
24 004 JUG COFFEE 0 0 0 0 0 0 0
25 005 JUG HOT WATER 0 0 0 0 0 0 0
26 006 COFFEE BLACK 0 0 0 0 0 0 0
27 007 HOT WATER 0 0 0 0 0 0 0
```

# primo



westomatic

## MINI/MIDI

# Save Error Log

### SAVE ERROR LOG:

You can save the error log on an SD Card.

The software Notepad++ is used to read the data - it's a free download available to everyone.

```
1  Generated on Fr, 30-07-2021, 14:54:55
2  Software version: V1.0.1207
3  Machine number: -
4
5  =====
6  =  ERROR LOG  =
7  =====
8  Number of errors: 5
9
10 01: E02 19-07-2021 12:13 E2 LEVEL ERROR
11 02: E02 19-07-2021 9:55 E2 LEVEL ERROR
12 03: E02 21-06-2021 12:17 E2 LEVEL ERROR
13 04: E02 07-05-2020 10:59 E2 LEVEL ERROR
14 05: E03 01-01-2010 0:03 E3 FILL ERROR
15
```

### SAVE ERROR LOG:

Place the SD Card into the machine.

- Open the rubber cover on the side of the screen.
- Insert the SD Card - golden contacts should face towards you.



### SAVE ERROR LOG:

From the SERVICE MENU  
08 SOFTWARE  
02 SAVE DATA

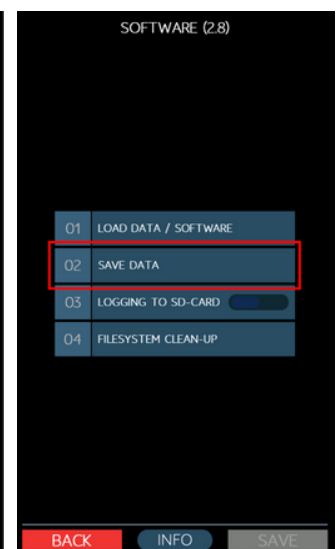
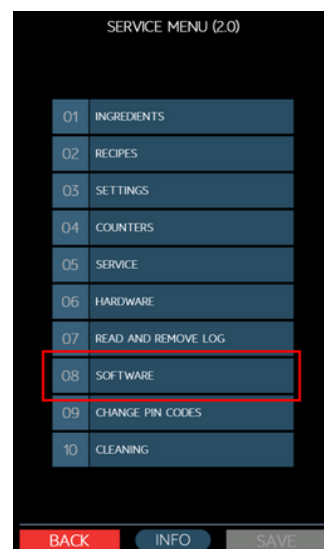



# Save Error Log

### SAVE ERROR LOG:

#### Save Data (2.8.2)

- Select 04 ERROR LOG and press OK to save the .err file on the SD Card.
- The counter file is saved on the SD Card / Reports / xxxxxx.err

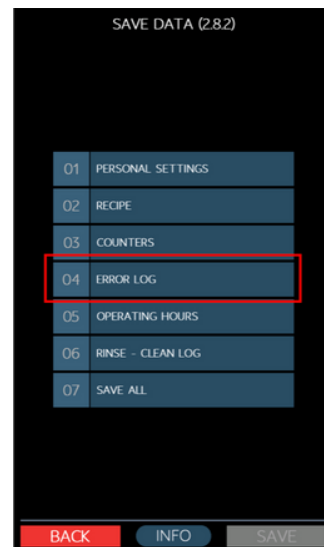

### SAVE ERROR LOG:

#### Remove the SD Card



### SAVE ERROR CODE:

Use Notepad++ on your computer to open the counter file on the SD Card / Reports / xxxxxx.err

#### The file shows you:

- The time/date the log file was generated
- Software version
- Machine number
- Every error which occurred by error name, time and date.
- The error log - maximum 30 errors, the oldest gets deleted.

```

1  Generated on Fr, 30-07-2021, 14:54:55
2  Software version: V1.0.1207
3  Machine number: -
4
5  =====
6  =  ERROR LOG  =
7  =====
8  Number of errors: 5
9
10 01: E02 19-07-2021 12:13 E2 LEVEL ERROR
11 02: E02 19-07-2021 9:55 E2 LEVEL ERROR
12 03: E02 21-06-2021 12:17 E2 LEVEL ERROR
13 04: E02 07-05-2020 10:59 E2 LEVEL ERROR
14 05: E03 01-01-2010 0:03 E3 FILL ERROR
15
    
```

# primo

## MINI/MIDI



Westomatic

# Save Rinse/Clean Log

## SAVE RINSE / CLEAN LOG:

You can save the rinse / clean log on an SD Card.

The software Notepad++ is used to read the data - it's a free download available to everyone.

```
Generated on Fr, 30-07-2021, 16:00:02
Software version: V1.0.1207
Machine number: -

CounterCleanMixer:
01: 30-07-2021 - 15:58:22

CounterRinseMixer:
01: 24-06-2021 - 12:40:38
02: 01-07-2021 - 14:27:32
```

## SAVE RINSE / CLEAN LOG:

Place the SD Card into the machine.

- Open the rubber cover on the side of the screen.
- Insert the SD Card - golden contacts should face towards you.



## SAVE RINSE / CLEAN LOG:

From the SERVICE MENU  
08 SOFTWARE  
02 SAVE DATA

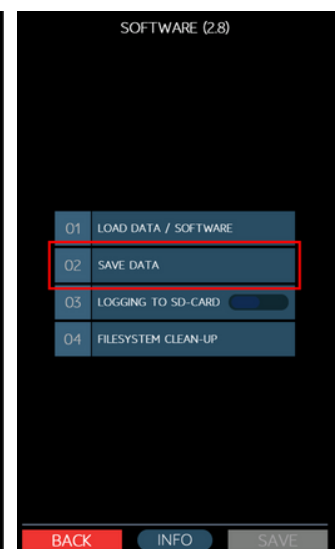
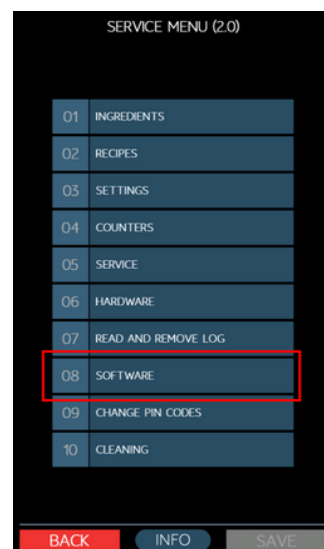

# primo



Westomatic

## MINI/MIDI

# Save Rinse/Clean Log

### SAVE RINSE / CLEAN LOG:

#### Save Data (2.8.2)

- Select 06 RINSE - CLEAN LOG and press OK to save the .cln file on the SD Card.
- The counter file is saved on the SD Card / Reports / xxxxxx.cln



### SAVE RINSE / CLEAN LOG:

#### Remove the SD Card



### SAVE RINSE / CLEAN LOG:

Use Notepad++ on your computer to open the counter file on the SD Card / Reports / xxxxxx.cln

#### The file shows you:

- The time/date the log file was generated
- Software version
- Machine number
- Date and time the machine was rinsed and cleaned.
- The log - maximum 30 inputs, the oldest gets deleted.

