



# Sigma

**HIGH PRESSURE BREWER  
CLEANING**

# HPB Cleaning

- 1** Daily:
- Flush the brewer - using the hot flush button
  - Remove and clean the stainless steel waste guide chute - mounted on the front of the brewer .
  - Empty Brewer - liquid and solid waste buckets are emptied.

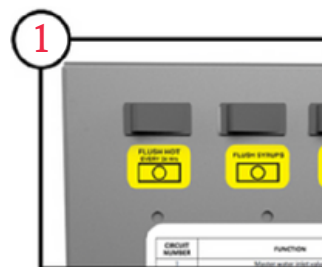

- 2** Weekly:
- Switch off the machine using the internal power switch
  - Remove and clean the stainless steel waste guide chute - mounted at the front of the brewer.
  - Disconnect the inlet and outlet tubes from the brewer
  - Remove the brewer and wash in warm, soapy water.

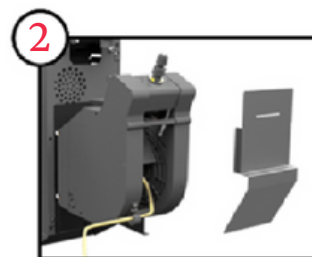

- 3**
- Rinse the brewer under cold water to get rid of any loose residue.
  - Thoroughly dry the brewer unit.
  - Spray a little food grade Lubricant PN: 1015013 onto the stainless steel drive rod.

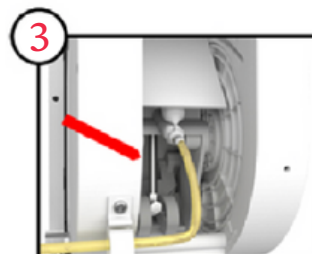

- 4**
- Refit brewer correctly into its housing
  - Reconnect the inlet & outlet tubes & fit waste guide chute.
  - Switch on the machine.
  - When the machine has reset - perform a 'cleaning cycle' using a Brewer Cleaning Tablet PN: 1015015 - **these MUST be used WEEKLY.**

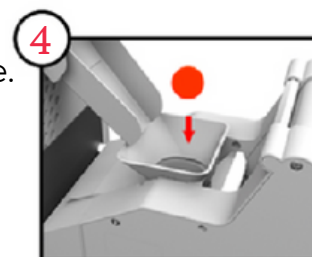

- 5**
- Enter OPERATOR FUNCTIONS
  - Select BREWER 2 and then select CLEAN BREWER
  - The display will prompt you to place a cleaning tablet into the chamber of the brewer and confirm to start the cleaning cycle.
  - The display/screen will indicate the progress.



# PARTS LIST

*Sigma*

westomatic

TOUCH  
CAFÉ  
SIMPLICITY



## Brewer Lubricant (Food Grade)

PN: 1015013



## Brewer Cleaning Tablets

PN: 1015015